

LÖWENSTEIN
medical

JOYCEone



Time-saving and custom-fit.

 With people in mind

JOYCEone. Made for you.



Forget about time-consuming adjustments. JOYCEone offers you a ventilation mask that almost always fits. It is the result of decades of mask expertise and is available as a nasal or full-face mask.

The perfect combination: Feeling of comfort and successful therapy

The forehead support with its flexible spring principle automatically ensures that it always sits firmly and comfortably on the forehead at the right distance for the particular therapy. The single-layer mask cushion works in an equally clever way. Thanks to its optimized shape it automatically finds the ideal position – irrespective of the nose or face size.

The advantages of JOYCEone

- Time-saving:
Automatic adjustment of forehead support **2** and mask cushion **1**
- Fool-proof assembly:
Clear color coding of headgear and headgear clips **4**
- Cost-effective: One size fits virtually all patients
- Convenient:
Easy to clean
- Pleasant:
Quiet and diffuse exhalation system **3**
- Hard-wearing: Extremely durable materials

Thought-out down to the smallest detail

Your patients will love JOYCEone from the moment they put it on! After all, JOYCEone not only stands out with its precise fit and wearing comfort, but also thanks to its ease of use: The unmistakable color coding of the headband and headgear clips with recessed grip makes JOYCEone quick and easy to put on correctly right from the start.

State-of-the-art efficiency

In a nutshell: The intelligent JOYCEone principle helps you make the best use of your time without having to compromise on patient care. **JOYCEone – made for you!**

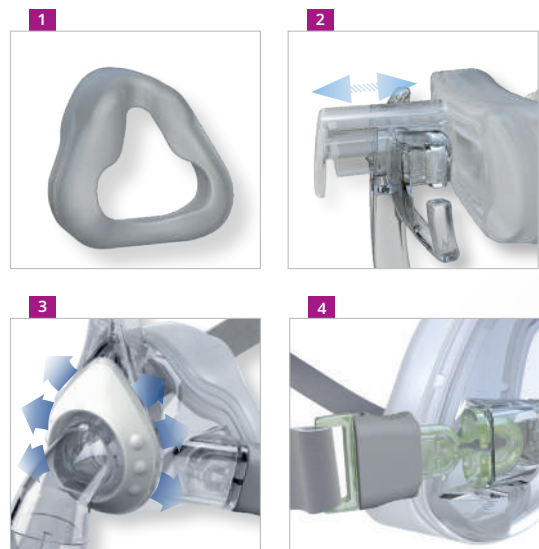

JOYCEone

Mask fits various
nose sizes



JOYCEone Full Face

Mask fits various
nose and face sizes



Accessories

Headgear

JOYCEone
incl. headgear clips
WM 25255

JOYCEone Full Face
incl. headgear clips
WM 25277

XL headgear
without headgear clips
WM 25338

Forehead cushion
silicone
WM 26801

Mask cushion

JOYCEone
silicone
WM 25253

JOYCEone Full Face
silicone
WM 25293

Elbow set

JOYCEone Full Face NV
retaining ring NV,
elbow NV
WM 25275

Endoscopy adapter set

JOYCEone Full Face NV
retaining ring NV,
elbow NV
WM 15864

Ball joint set

JOYCEone
retaining ring, elbow,
rotating sleeve
WM 15908

JOYCEone Full Face
retaining ring, elbow,
anti-asphyxia valve,
rotating sleeve
WM 15944

Quick-release cord
quick-release
feature
WM 26890

Further information about our therapy solutions, accessories and mask systems is available at loewensteinmedical.com

Technical specifications

	JOYCEone	JOYCEone Full Face	JOYCEone Full Face NV		JOYCEone	JOYCEone Full Face	JOYCEone Full Face NV
Product class to MDR (EU) 2017/745	II a			Flow resistance, anti-asphyxia valve			
Dimensions (W x H x D)	approx. 96 x 115 x 83 mm	approx. 89 x 155 x 97 mm		• Inspiration at 50 l/min:	-	0.8 hPa ±0.1 hPa	-
Weight	87 g	127 g	127 g	• Expiration at 50 l/min:	-	0.6 hPa ±0.1 hPa	-
Therapy pressure range	4 to 30 hPa			Switching pressure Anti-asphyxia valve			
Volume of dead space	90 ml	240 ml		• Open:	-	≤ 0.5 hPa	-
Tapered tube connection to EN ISO 5356-1	Ø 22 mm (male)		Ø 22 mm (female)	• Close:	-	≤ 0.8 hPa	-
Temperature range				Quoted two-digit noise emission value to ISO 4871:			
• Operation:	+5 °C to +40 °C			• Sound pressure level:	19 dB(A)	-	-
• Transport and storage:	-20 °C to +70 °C			• Sound power level:	27 dB(A)	-	-
Flow resistance				• Uncertainty factor:	3 dB(A)	-	-
• at 50 l/min	0.2 hPa ±0.1 hPa	0.3 hPa ±0.1 hPa	0.03 hPa ±0.1 hPa	Useful life	up to 12 months ¹		
• at 100 l/min	0.9 hPa ±0.1 hPa	0.7 hPa ±0.1 hPa	0.11 hPa ±0.1 hPa	Service life	5 years		
				Standards applied	EN ISO 17510:2020		

¹ Materials used to manufacture masks will age if exposed to aggressive detergents, for example. In individual cases, it may therefore be necessary to replace mask parts sooner.

Device name	Article no.	HMV item no.
JOYCEone	WM 25260	14.24.16.2052
JOYCEone Full Face	WM 25290	14.24.16.6049
JOYCEone Full Face NV	WM 25270	14.24.16.1024

CE 0197



Löwenstein Medical Technology
Kronsaalweg 40
22525 Hamburg, Germany

Sales + Service

Löwenstein Medical
Arzbacher Strasse 80
56130 Bad Ems, Germany
T. +49 2603 9600-0
F. +49 2603 9600-50
info@loewensteinmedical.com
loewensteinmedical.com

